

4 OPzS 200 (2 V 200Ah)

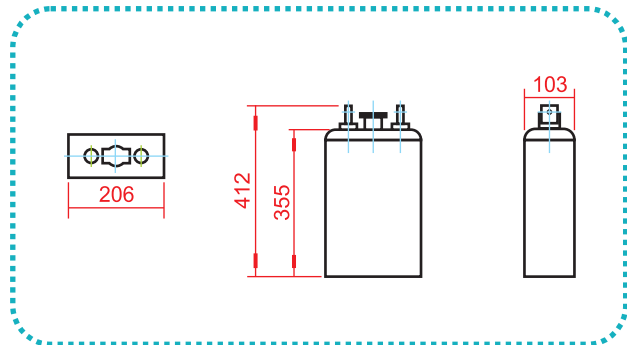

Outer Dimensions (mm)



Specifications

Nominal Voltage		2 V
Rated Capacity (10 Hour Rate)		200 Ah
Dimensions	Total Height	412 mm
	Height	355 mm
	Length	206 mm
	Width	103 mm
Weight of Dry Battery ($\pm 2.5\%$)		12.6 Kg
Weight of Electrolyte		4.8 Kg

Terminal Type (mm)

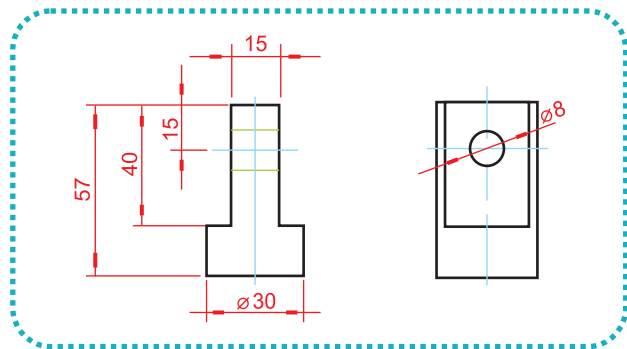

SINGLE CELL BATTERIES

TYPE ACCORDING TO DIN 40736	Capacity		Discharge		Charging			Size of Plates in Ah at 10 hours rate of discharge OPzS
	in Ah	rate of discharge (hours)	(A)	until final voltage V/cell	to 2.4 V/cell (A)	over 2.4V/cell		
						falling by (A)	falling to (A)	
4 OPzS 200	200 170 150	10 5 3	20 34 50	1.82 1.79 1.77	30	14	7	50

Constant Current (A) Discharge Table at 25°C (77°F)

Final Voltage	DISCHARGE TIME								
	30 min	1 h	2 h	3 h	4 h	5 h	6 h	8 h	10 h
1.90 V	81	65.2	46	36	30.4	26.6	23.4	19.2	16.2
1.87 V	95	74.8	51.6	40	33.6	29.2	25.8	21	17.6
1.83 V	111	85.6	58	44.8	36.8	31.8	28.4	22.8	19
1.80 V	122	92	61.6	47.2	38.6	33.2	29.6	24	20
1.75 V	142	100	66.4	50.4	40.8	35	31.2	25.2	—
1.70 V	156	108	69.6	52.4	42.4	36.2	32	—	—