

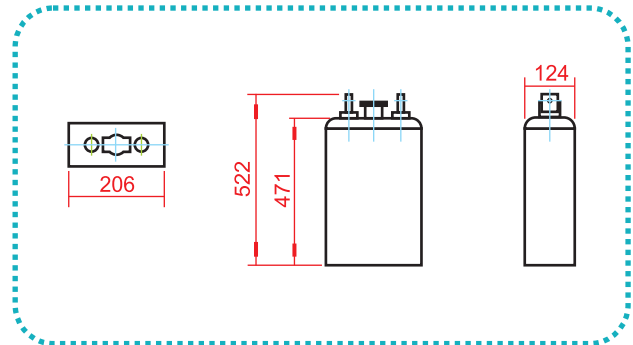

Outer Dimensions (mm)



Specifications

Nominal Voltage		2 V
Rated Capacity (10 Hour Rate)		350 Ah
Dimensions	Total Height	522 mm
	Height	471 mm
	Length	206 mm
	Width	124 mm
Weight of Dry Battery (±2.5%)		20.7 Kg
Weight of Electrolyte		8.6 Kg

Terminal Type (mm)

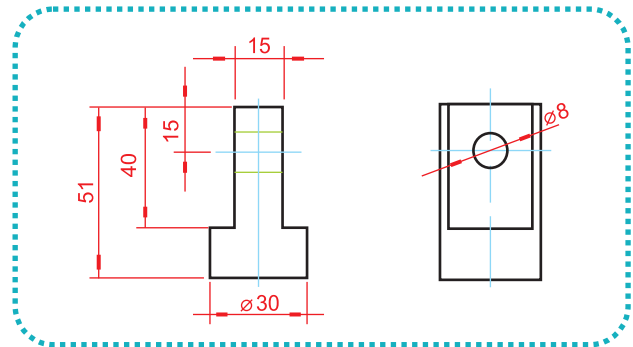

SINGLE CELL BATTERIES

TYPE ACCORDING TO DIN 40736	Capacity		Discharge		Charging			Size of Plates in Ah at 10 hours rate of discharge OPzS
	in Ah	rate of discharge (hours)	(A)	until final voltage V/cell	to 2.4 V/cell (A)	over 2.4V/cell		
						falling by (A)	falling to (A)	
5 OPzS 350	350 300 264	10 5 3	35 60 88	1.82 1.79 1.77	53	24	12	70

Constant Current (A) Discharge Table at 25°C (77°F)

Final Voltage	DISCHARGE TIME								
	30 min	1 h	2 h	3 h	4 h	5 h	6 h	8 h	10 h
1.90 V	121	99	70	57	48.5	43	37.5	32.5	29.5
1.87 V	148	118	84	67	56.5	49	43	36	31
1.83 V	179	140	98.5	77	64.5	55	47.5	39	33
1.80 V	199	154	106	82	68	58	50	40.5	34
1.75 V	231	171	115	88	72.5	61.5	52.5	42	—
1.70 V	254	185	122	92	75	64	54	—	—