

# 12 MC 7 (12V 7Ah) motorcycle use

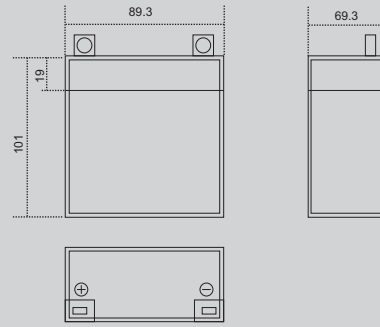

## Outer Dimensions (mm)



## Specifications

|                                 |              |                  |
|---------------------------------|--------------|------------------|
| Nominal Voltage                 |              | 12 V             |
| Rated Capacity ( 10 Hour Rate ) |              | 7 Ah             |
| Dimensions                      | Total Height | 101 mm           |
|                                 | Height       | 101 mm           |
|                                 | Length       | 138 mm           |
|                                 | Width        | 66 mm            |
| Container Material              |              | ABS (UL94-HB/V0) |
| Weight Approx (±2.5%)           |              | 2.3 Kg           |

## Terminal Type (mm)

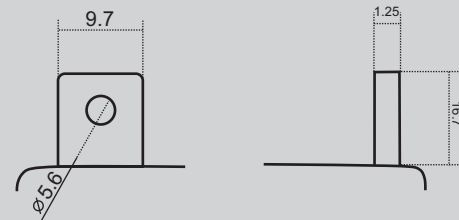

## Characteristics

|                                  |                                        |         |
|----------------------------------|----------------------------------------|---------|
| Capacity<br>25°C (77°F)          | 10 hour-rate                           | 7 Ah    |
|                                  | 3 hour-rate                            | 5.15 Ah |
|                                  | 1 hour-rate                            | 3.64 Ah |
| Internal Resistance              | Full Charge Battery at 25°C (77°F)     | 20 mΩ   |
| Self-Discharge<br>at 25°C (77°F) | Capacity After The 3 Month of Storage  | 91 %    |
|                                  | Capacity After The 6 Month of Storage  | 82 %    |
|                                  | Capacity After The 12 Month of Storage | 64 %    |

## Discharge Curves 25°C (77°F)

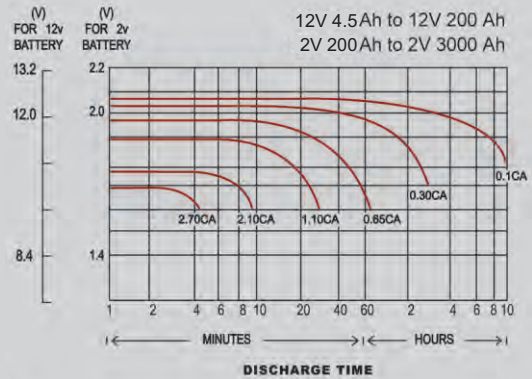

International Standard Number : JIS D 5302(1997)

ISIRI Number : 6197 ( 1<sup>st</sup> Edition)